

ALUMINUM ELECTROLYTIC CAPACITORS

PG-6SR 731 - 220000MFD - 40VDC - 76X145 - AEST-D(Provisional)

DATE :26-05-2014

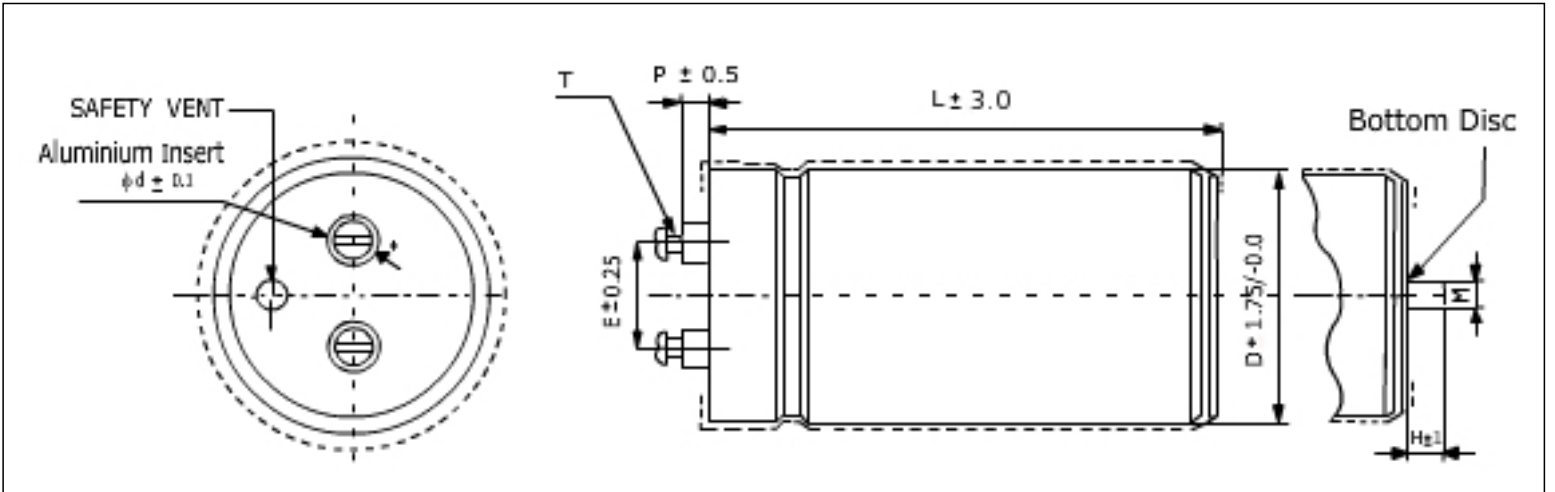

Note: ALL DIMENSIONS ARE IN MM

Dimensions

D	L	E	P	T	d	M	H	Terminal Style
76	145	31.6	7.8	M5X0.8pX10	12	12	16	AEST-D

Electrical parameters



Capacitance Tolerance	$\pm 20\%$
Rated Voltage DC	40 Vdc
Surge Voltage	46 Vdc
Typical ESR (at 100 Hz and 25°C)	0.005 Ohm
Max ESR (at 100 Hz and 25°C)	0.008 Ohm
Max Leakage Current (After 5 min of applying rated voltage)	26400 μ A
Max Ripple Current (at 100 Hz and 85°C)	31.5 Amp
Temperature Range	-40°C to +85°C
Nominal Capacitance at 100 Hz and 25°C	220000
Max tan D (at 100 Hz and 25°C)	1
Max Impedance (at 10 kHz and 25°C)	0.005 Ohm
Useful life	20000h at 85°C, rated voltage, Rated Ripple Current
After Test	
Change in Capacitance	$\leq \pm 30\%$ of initial value
ESR	≤ 3 X initial spec value
Leakage Current	\leq Initial spec. limit

Multiplying Factor for Ripple Current at other Temperatures

+40°C	+45°C	+50°C	+65°C
2.10	2.00	1.90	1.60

Ripple Current Capacity at other Frequency

Frequency Hz	100	250	500	1K to 1K	>10K
Multiplying Factor	1.00	1.05	1.20	1.32	1.35

Prepared By 	Verified By 	Approved By 
---	---	---