

## ALUMINUM ELECTROLYTIC CAPACITORS

PG-6SR 589 - 150000MFD - 63VDC - 76X145 - AEST-D( Provisional)

DATE :03-01-2013

Revision Status: 001

Revision Date : 14-03-2013

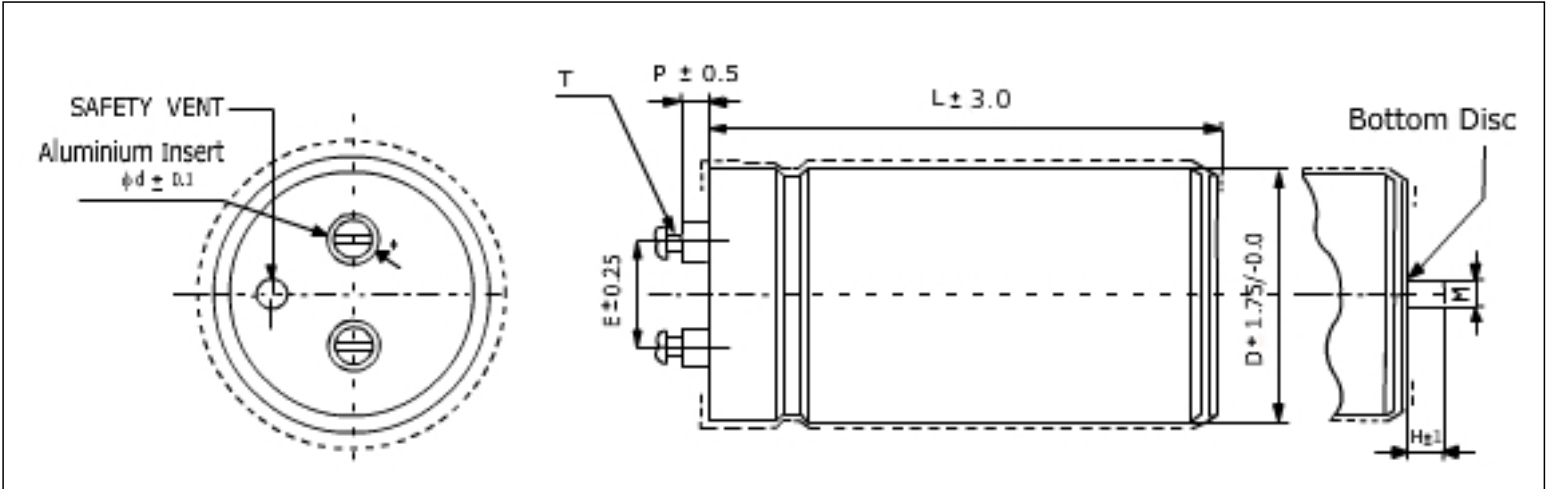

**Note:** ALL DIMENSIONS ARE IN MM

### Dimensions

D	L	E	P	T	d	M	H	Terminal Style
76	145	31.6	7.8	M5X0.8pX10	12	12	16	AEST-D

### Electrical parameters

Nominal Capacitance at 100 Hz and 25°C	150000 MFD
Capacitance Tolerance	±20%
Rated Voltage DC	63 Vdc
Surge Voltage	75 Vdc
Max ESR (at 100 Hz and 25°C)	0.006 Ohm
Max Tan delta (at 100Hz and 25°C)	0.95
Max Impedance (at 10 kHz and 25°C)	0.006 Ohm
Max Leakage Current ( After 5 min of applying rated voltage)	6000 µA at 25°C
Max Ripple Current ( at 100 Hz and 85°C )	36.1 Amp
Temperature Range	-40°C to +85°C
Expected life	12000 hours at 85°C

### Multiplying Factor for Ripple Current at other Temperatures

+40°C	+45°C	+50°C	+65°C
2.10	2.00	1.90	1.60

### Ripple Current Capacity at other Frequency

Frequency Hz	100	250	500	1K to 10K	>10K
Multiplying Factor	1.0	1.05	1.20	1.32	1.35

Prepared By <i>R. Jayap</i>	Verified By <i>Chandras</i>	Approved By <i>S. Srinivas</i>
--------------------------------	--------------------------------	-----------------------------------